

Audio Visual Equipment & Packages



Silver Cloud Hotel Seattle Stadium

1046 1st Avenue South Seattle Washington 98134

(206) 204 - 9800

Audio Visual Packages

<p><i>Package A</i> (Small Meetings)</p> <p>\$135</p> <p><i>A la Carte Price: \$180</i></p>	<p><i>Package B</i> (Standard Meetings)</p> <p>\$295</p> <p><i>A la Carte Price: \$395</i></p>	<p><i>Package C</i> (Standard Plus Meetings)</p> <p>\$355</p> <p><i>A la Carte Price: \$470</i></p>	<p><i>Package D</i> (Full Meeting Package)</p> <p>\$455</p> <p><i>A la Carte Price: \$604</i></p>
<p>Includes:</p> <ul style="list-style-type: none"> • Plasma TV • 25' VGA Cable (PC & Mac compatibility) • Speakerphone • 1 Flip Chart/Whiteboard & Markers 	<p>Includes:</p> <ul style="list-style-type: none"> • 1 LCD Projector • 1 8ft Screen • Power Cords/Extension Cords (up to 3) • AV Cart • 1 Flip Chart/Whiteboard & Markers • 1 Wireless PowerPoint remote <p>\$150 For an additional projector & Screen</p>	<p>Includes:</p> <ul style="list-style-type: none"> • 1 LCD Projector • 1 8ft Screen • Power Cords/Extension Cords (up to 3) • AV Cart • Speakerphone • 1 Flip Chart/Whiteboard & Markers • 1 Wireless PowerPoint remote 	<p>Includes:</p> <ul style="list-style-type: none"> • 1 LCD Projector • 1 8ft Screen • Power Cords/Extension Cords (up to 3) • AV Cart • 1 Microphone (Wireless or Handheld) • 1 Podium • 1 Flip Chart/Whiteboard & Markers • Audio Patch • 1 Wireless PowerPoint Remote

Complimentary Wi-Fi is available in all meeting rooms.

There is a 20% service charge & 9.5% tax added to all audio visual rental charges.

Audio Visual Pricing

<i>Equipment</i>	<i>Daily Rental Fees</i>
Plasma TV package <i>Includes: TV & 25' VGA Cable</i> <i>(PC and Mac compatibility)</i>	\$60
LCD Projector	\$250
Stand Alone Easel for Signage/Flip Chart Stand	\$15
Flipchart/Whiteboard/Markers Package	\$45
Floor Podium	\$65
Audio Patch	\$45
Speakerphone	\$75
Power Strips/Extension Cords	\$15
Wireless Lavalier or Wireless Handheld Microphone	\$99
Wireless PowerPoint Remote	\$40

If you need additional A/V equipment, please let us know & we will be glad to assist you.

Please allow at least three (3) business days to rent A/V equipment from an offsite vendor.

EVENT SPACE CAPACITIES

Room	Sq. Ft.	Ceiling	U-Shape	Boardroom	Hollow Square	Classroom	Banquet Rounds	Theater	Reception
Avenue One Ballroom	2250	8'10"	60	60	60	100	120	175	200
Avenue One North Room	1140	8'10"	33	33	33	50	60	84	100
Avenue One South Room	1110	8'10"	33	33	33	50	60	84	100
Royal Brougham Room	400	9'	15	16	18	20	30	32	40
Executive Boardroom	192	8'	n/a	6	n/a	n/a	n/a	n/a	n/a
Foyer	504	-	-	-	-	-	-	-	-

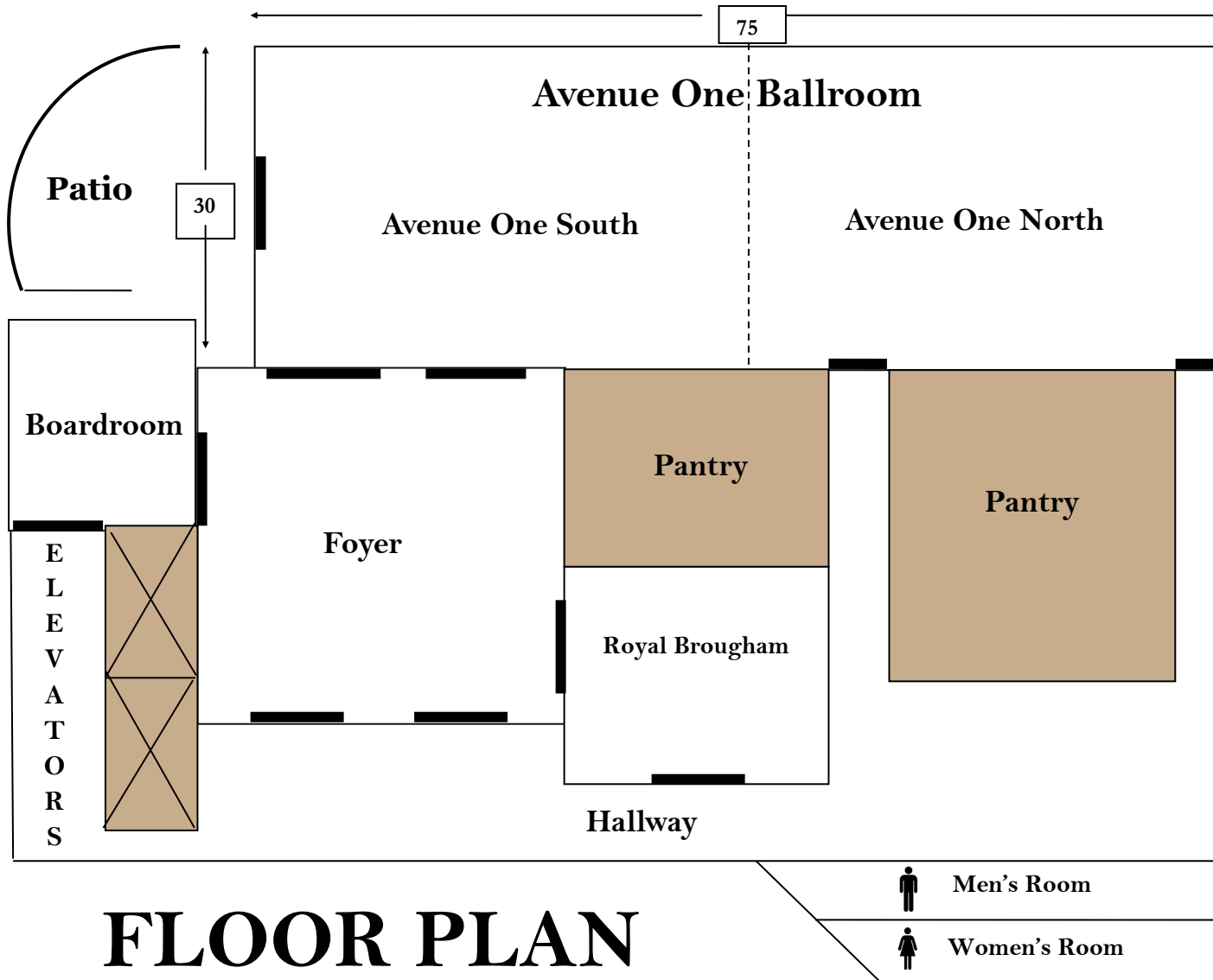

FLOOR PLAN